

PROJECT DATA

ADDRESS
3700 E MERCER WAY
MERCER ISLAND, WA 98040

OWNER
HERZEL-NER-TAMID CONSERVATIVE CONGREGATION

LEGAL DESCRIPTION
PARCEL A: (APN 082405-9045-07)
THAT PORTION OF GOVERNMENT LOT 11, SECTION 8, TOWNSHIP 24 NORTH, RANGE 5 EAST, W.M., IN KING COUNTY, WASHINGTON; TOGETHER WITH THAT PORTION OF THE SOUTHEAST QUARTER OF SECTION 7, TOWNSHIP 24 NORTH, RANGE 5 EAST, W.M., IN KING COUNTY, WASHINGTON, DESCRIBED AS FOLLOWS:
BEGINNING AT THE INTERSECTION OF THE WEST LINE OF GOVERNMENT LOT 11 WITH THE NORTH LINE OF DOYLE-HANSEN ADDITION, ACCORDING TO THE PLAT THEREOF RECORDED IN VOLUME 75 OF PLATS, PAGE 24, RECORDS OF KING COUNTY, WASHINGTON;
THENCE SOUTH 89°09'34" EAST SLOING THE NORTH OF SAID DOYLE-HANSEN ADDITION, A DISTANCE OF 253.49 FEET TO THE WEST LINE OF LOT 7 OF CHANNEL CREST, ACCORDING TO THE PLAT THEREOF RECORDED IN COLLUME 72 OF PLATS, PAGE 63, RECORDS OF KING COUNTY, WASHINGTON;
THENCE NORTH 01°12'29" EAST ALONG SAID WEST LINE, A DISTANCE OF 111.48 FEET TO THE SOUTH LINE OF TRACT "A" OF SAID CHANNEL CREST; THENCE SOUTH 85°39'49" WEST ALONG SAID SOUTH LINE 173.15 FEET TO SOUTHEASTERLY LINE OF LAND CONVEYED TO STATE OF WASHINGTON TOLL BRIDGE AUTHORITY UNDER RECORDING NO. 30322-009;
THENCE SOUTH 65°24'55" WEST ALONG SOUTHEASTERLY LINE TO THE EASTERLY MARGIN OF EAST MERCER WAY, AS CONVEYED TO KING COUNTY UNDER RECORDING NO. 923897;
THENCE SOUTH 01°02'29" WEST TO THE NORTH LINE OF SAID DOYLE-HANSEN ADDITION;
THENCE SOUTH 89°09'34" EAST ALONG SAID NORTH LINE 70.61 FEET TO THE POINT OF BEGINNING.

PARCEL B: (APN 210700-0010-06)
LOTS 1 THROUGH 5, INCLUSIVE, DOYLE-HANSEN ADDITION, ACCORDING TO THE PLAT THEREOF RECORDED IN VOLUME 75 OF PLATS, PAGE 24, RECORDS OF KING COUNTY, WASHINGTON.

PARCEL C: (APN 151560-0010-06)
LOTS 1 THROUGH 7, INCLUSIVE, CHANNEL CREST, ACCORDING TO THE PLAT THEREOF RECORDED IN VOLUME 72 OF PLATS, PAGE 63, RECORDS OF KING COUNTY, WASHINGTON;

TOGETHER WITH AN UNDIVIDED 7/8THS INTEREST IN TRACT "A" OF SAID PLAT.

SITUATE IN THE COUNTY OF KING, STATE OF WASHINGTON.

ASSESSOR'S PARCEL NUMBER
0824059045, 1515600010, 2107000010, 151560TRCT

SCOPE OF WORK
CONSTRUCTION OF A 3-STORY SCHOOL AND OFFICE BUILDING.

anjali grant design LLC

3427 BEACON AVE S
SEATTLE 98144
ANJALI@AGRANTDESIGN.COM
206-512-4209

NOT FOR CONSTRUCTION

2 SITE PLAN-ENLARGED
1/16" = 1'-0"

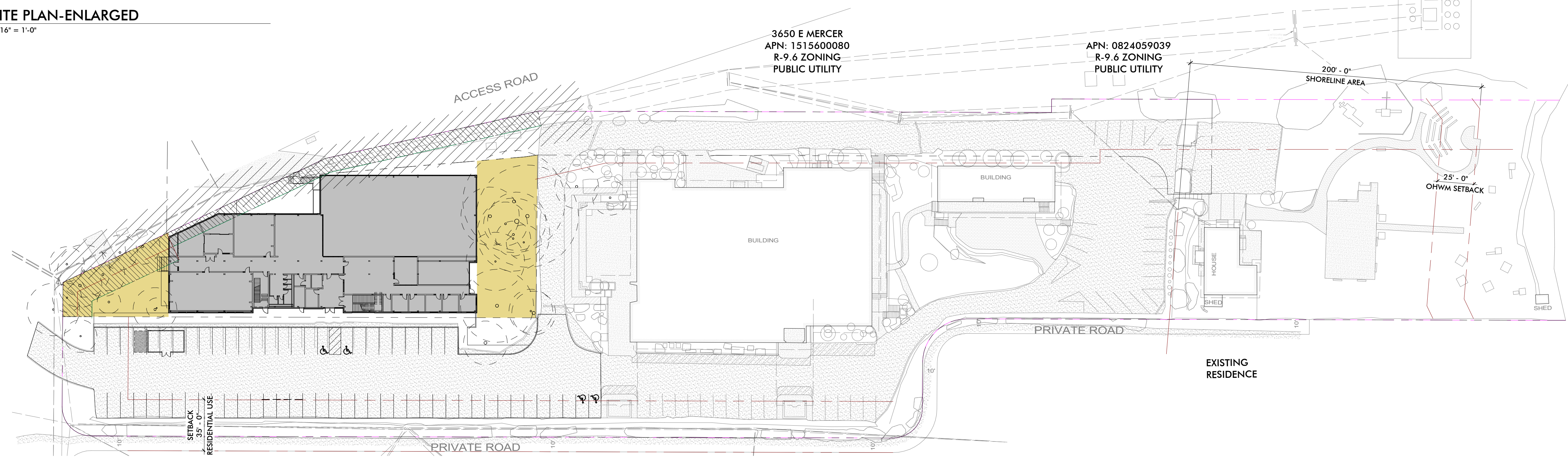

1 SITE PLAN-OVERALL
1" = 40'-0"

NO.	DATE	DESCRIPTION
	2/6/2024	SD PRICING SET
PROJECT:		XXXX

LAND USE/SITE PLAN

A-010

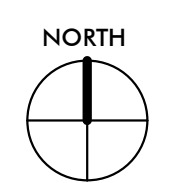

2/6/2024 2:52:16 PM Anjali Grant Design, LLC - Seattle, WA
© ANJALI GRANT DESIGN LLC ORIGINAL SHEET SIZE: 24" x 36"